

- NOTES:
- DO NOT SCALE. USE FIGURED DIMENSIONS ONLY.
 - THIS DRAWING IS TO BE READ IN CONJUNCTION WITH ALL OTHER RELEVANT ARCHITECTURAL AND ENGINEERING DRAWINGS.

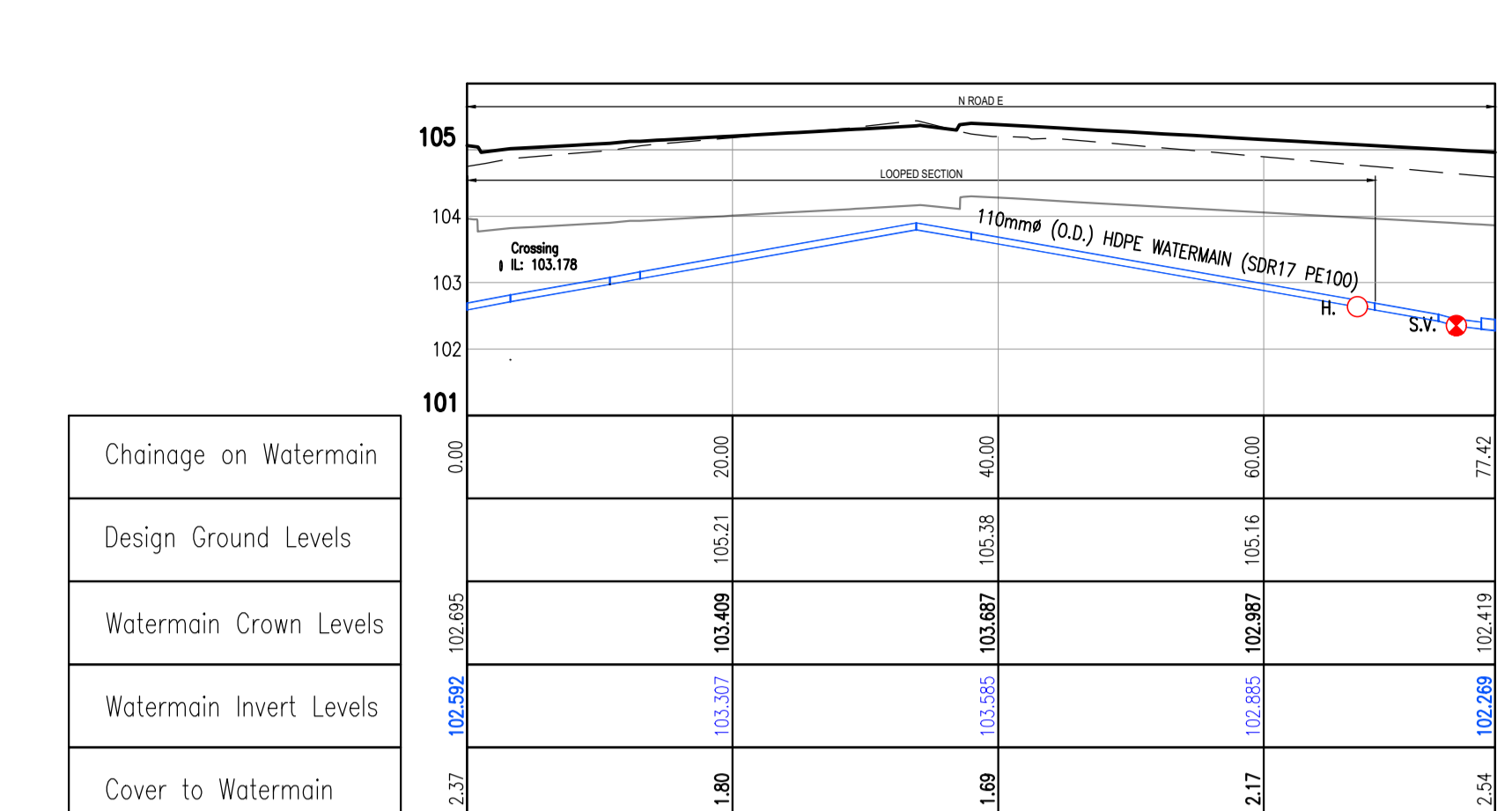
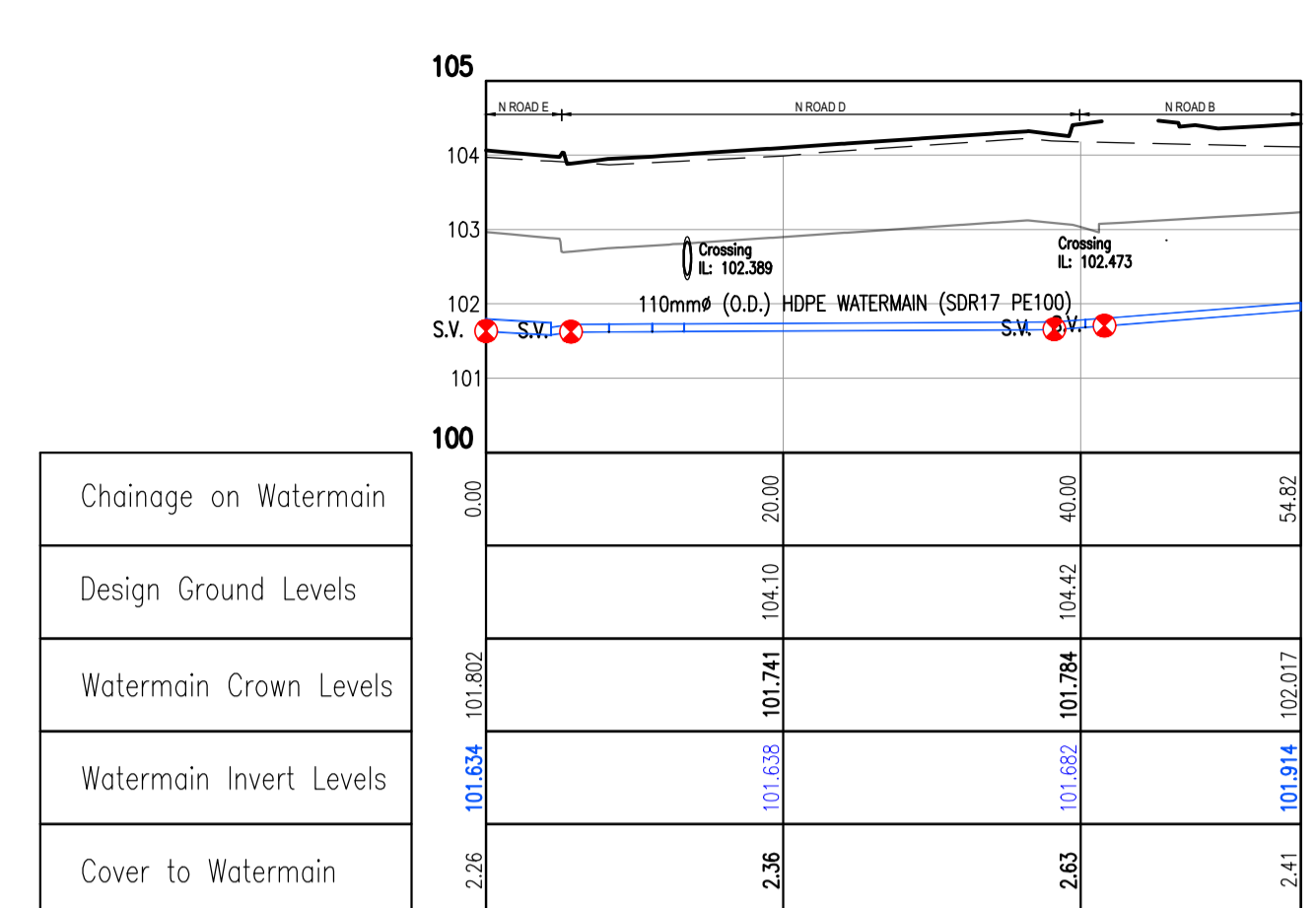
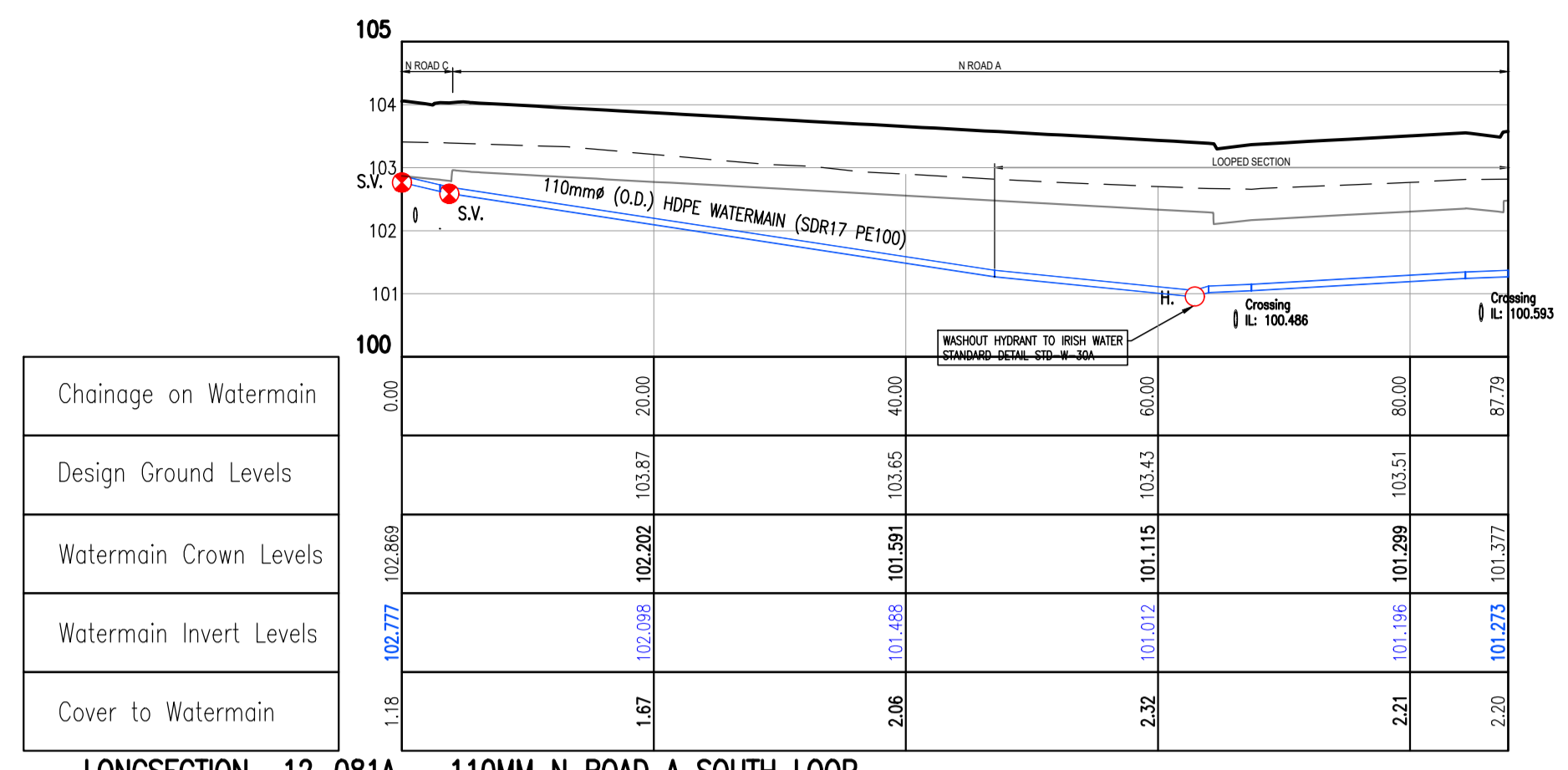

LONGSECTION 12-081A - 110MM N ROAD A SOUTH LOOP
H-SCALE 1:500 V-SCALE 1:100

LONGSECTION 12-081A - 110MM LINK N ROAD E TO N ROAD B
H-SCALE 1:500 V-SCALE 1:100

LONGSECTION 12-081A - 110MM N ROAD E LOOP
H-SCALE 1:500 V-SCALE 1:100

LEGEND

- DESIGNED GROUND PROFILE
- EXISTING GROUND PROFILE
- 1200mm COVER
- S.V. SLUICE VALVE
- A.V. AIR VALVE
- H. HYDRANT
- PROPOSED WATER PIPES
- CROSSING PIPES

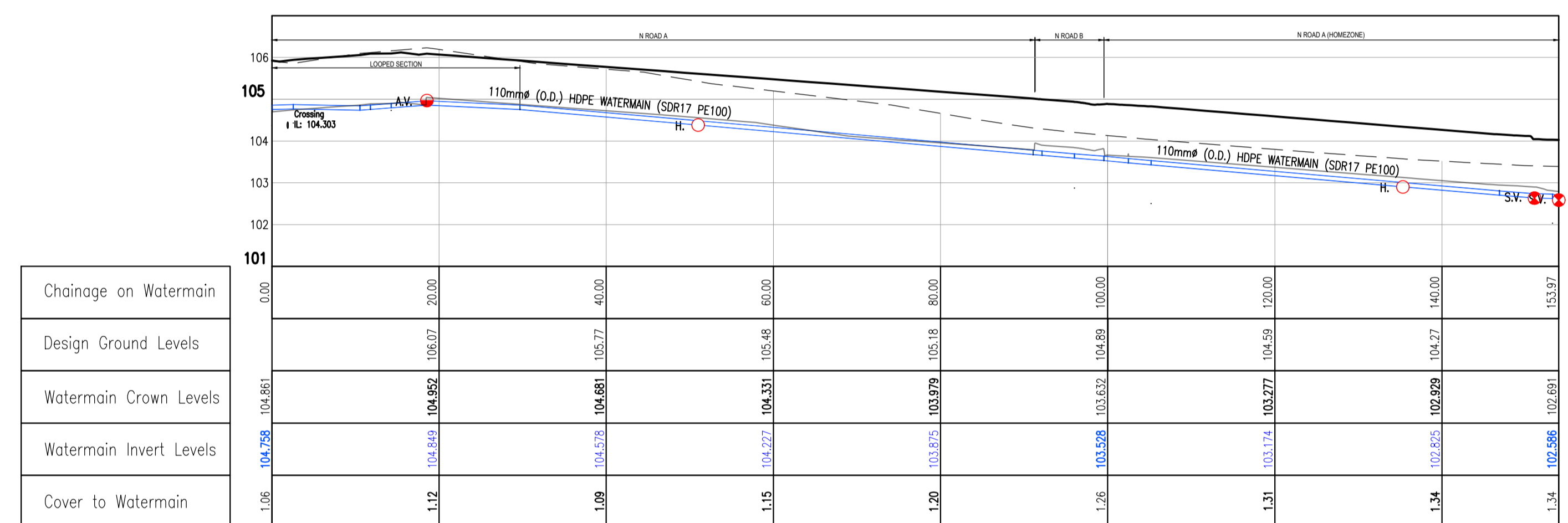

LONGSECTION 12-081A - 110MM N ROAD A PARK TO NORTH LOOP
H-SCALE 1:500 V-SCALE 1:100

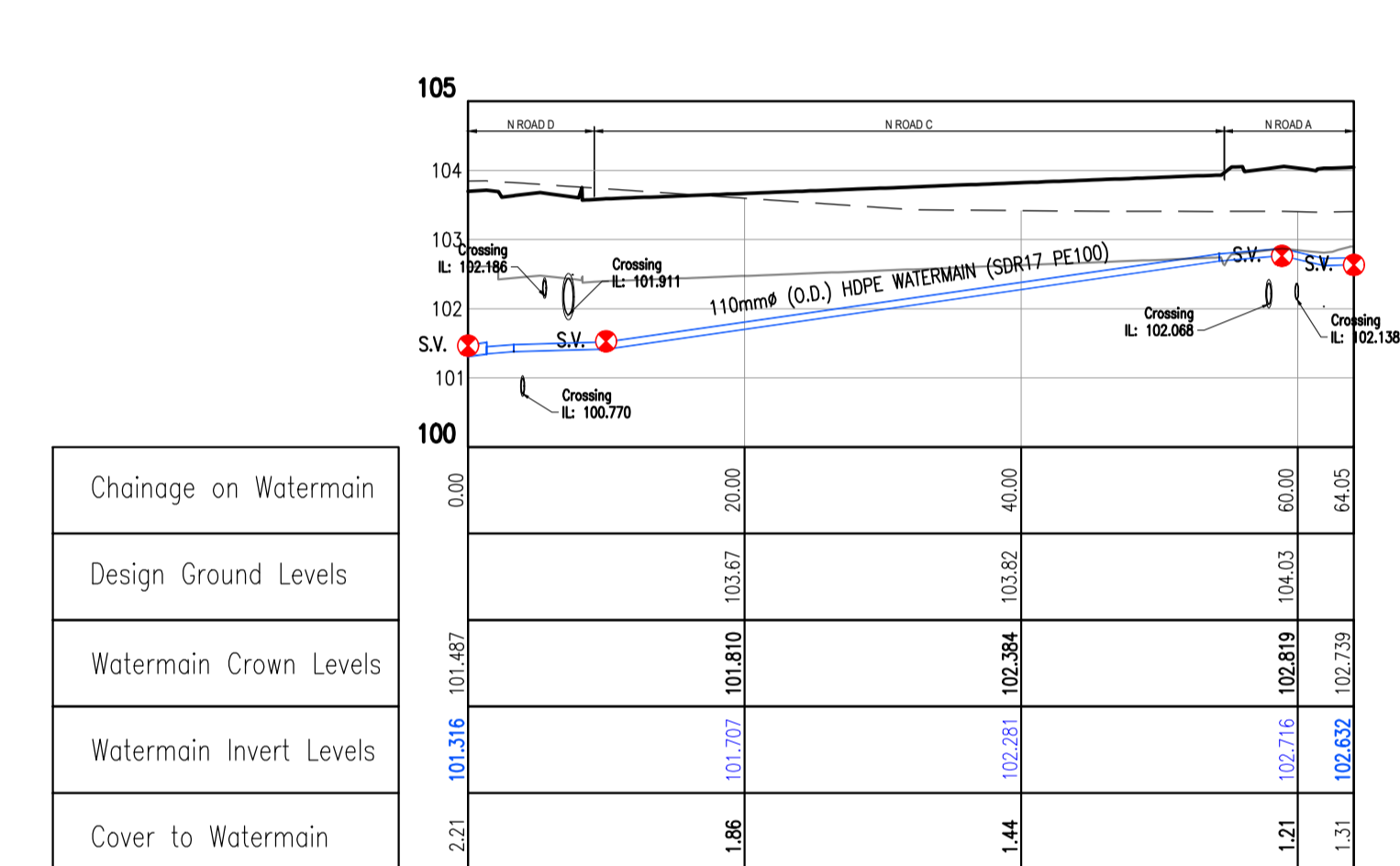

LONGSECTION 12-081A - 110MM N ROAD C
H-SCALE 1:500 V-SCALE 1:100

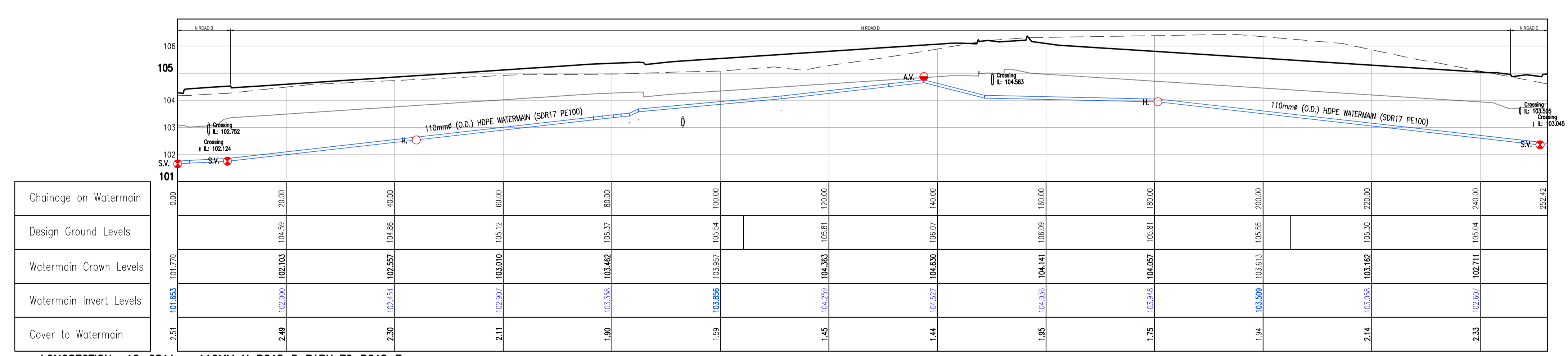

LONGSECTION 12-081A - 110MM N ROAD D PARK TO ROAD E
H-SCALE 1:500 V-SCALE 1:100

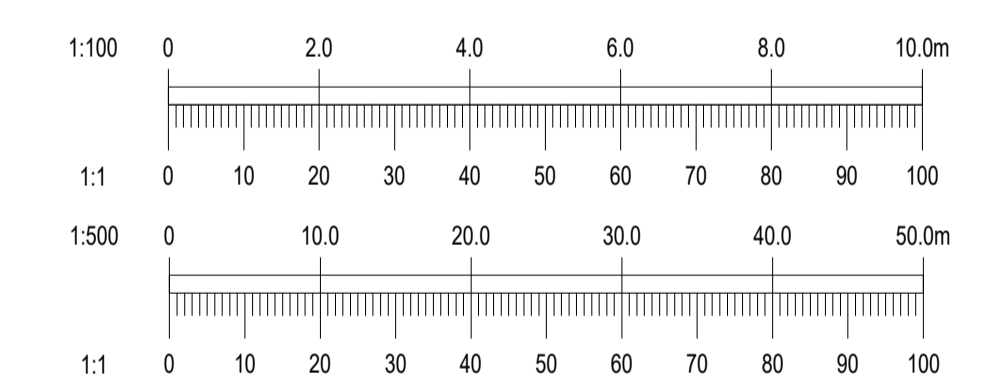

REV.	02/10/20	SHD APPLICATION ISSUE	MK	IS
REV.		AMENDMENT	DRN	APPD

STATUS **FOR SHD APPLICATION**

Waterman Moylan
Engineering Consultants

BLOCK 5, EASTPOINT BUSINESS PARK, ALFIE BYRNE ROAD,
DUBLIN D03 H3F4 IRELAND. Tel: (01) 664 9900
Email: info@waterman-moylan.ie www.waterman-moylan.ie

CLIENT	CASTELTHORN CONSTRUCTION ULC
ARCHITECT	O'MAHONY PIKE ARCHITECTS
PROJECT	PROPOSED PHASE 2 RESIDENTIAL DEVELOPMENT AT DUNSHAUGHLIN, CO. MEATH
TITLE	WATERMAIN LONG SECTIONS SHEET 1 OF 6

DRAWN	DESIGNED	APPROVED	DATE
MK	KV	IS	OCT. 2020
SCALE	JOB NO.	DRG. NO.	REVISION
AS SHOWN @ A1	12-081A	P320	~